

*An unprecedented level of detail and elegance found in your home*  
*at*

## KIRKWOOD PARK

You have discovered a rare opportunity to be a part of a charming community, designed to feel like a quaint southern village. Announcing the opening of KIRKWOOD PARK, conveniently located in the heart of North Raleigh on Millbrook Road between Creedmoor Road and Lead Mine Road.

Select from four southern classic sophisticated designs or call to view our portfolio of distinct homes that are suitable for this community. These two-story majestic homes are outlined by lush landscaping.

Only 13 homesites will be offered in this alluring area known for its natural beauty and conveniences. Stroll one-half mile to 50-acre Shelley Lake or drive less than two miles to one of the area's largest shopping malls.

KIRKWOOD PARK, a welcoming place for your entire family. Discover the advantages today!

For more information contact



**Jonathan C. Barefoot**

**Phone: 919.785.4329**

**Cell: 919.971.3810**

or

[jonathan@fmbnewhomes.com](mailto:jonathan@fmbnewhomes.com)

[www.fmbnewhomes.com](http://www.fmbnewhomes.com)

*Feel the difference!*

Gold Award-Winning Custom Builder

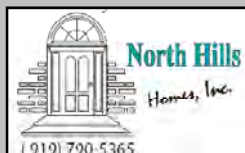

Visit: [www.NorthHillsHomesInc.com](http://www.NorthHillsHomesInc.com)



**The Granville** **SOLD**

1922 Kirkwood Ridge Drive, Raleigh, NC  
5 BRs • 3 Full & 2 Half Baths • 3838 sq.ft



**The Bayleaf**

5720 Kirkwood Park Drive, Raleigh, NC  
5 BRs • 3.5 Baths • 3450 sq.ft.



Coming Soon!

**The Lassiter**

5/6 BRs • 3.5 Baths • 3477 sq.ft.



**The Creston** **SOLD**

1926 Kirkwood Ridge Drive, Raleigh, NC  
4 BRS • 3.5 Baths • 3420 sq.ft.

# KIRKWOOD PARK

MILLBROOK ROAD . RALEIGH, NC 27612 . (919) 790-5365  
WWW.NORTHHILLSHOMESINC.COM

	Sold
	The Granville
	The Bayleaf
	The Creston
	The Lassiter

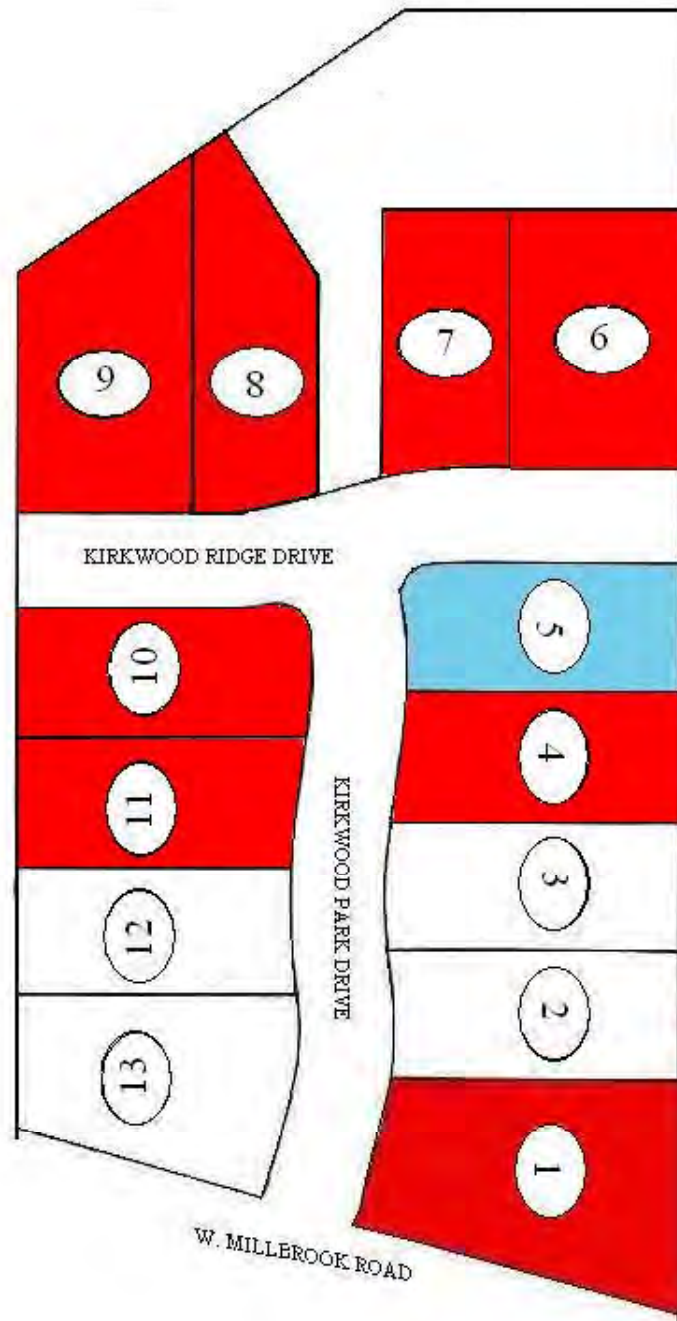
**Directions:**

I-440 to Glenwood (Hwy 70W)  
First Right on Leadmine  
Left on Millbrook  
Kirkwood Park on Right

Distinctive Community by North Hills Homes, Inc.